

## 18.AUX Input Terminal

### A: REMOVAL

#### 1. AUX UNIT

1) Disconnect the ground cable from battery. <Ref. to NT-5, BATTERY, NOTE, Note.>

NOTE:

For models other than STI model, disconnect the ground terminal from battery sensor.

2) Remove the console box assembly. <Ref. to EI-67, REMOVAL, Console Box.>

3) Release the claws, and then remove the unit - AUX terminal.

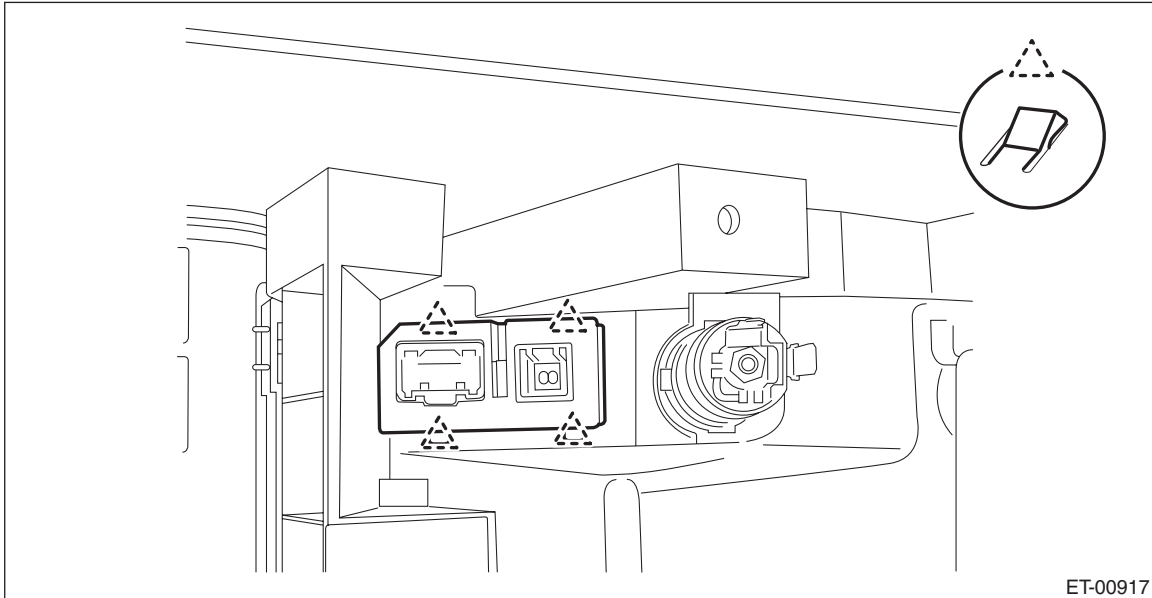

#### 2. AUX FEEDER CORD

1) Disconnect the ground cable from battery. <Ref. to NT-5, BATTERY, NOTE, Note.>

NOTE:

- On CVT models, shift the select lever into “D” before disconnecting the battery ground cable.
- For models other than STI model, disconnect the ground terminal from battery sensor.

2) Remove the console box. <Ref. to EI-67, REMOVAL, Console Box.>

3) Remove the panel center assembly. <Ref. to EI-66, REMOVAL, Center Console.>

4) Remove the audio assembly or navigation assembly. <Ref. to ET-8, REMOVAL, Audio.>

5) Remove the clamps and remove the cord assembly - AUX feeder.

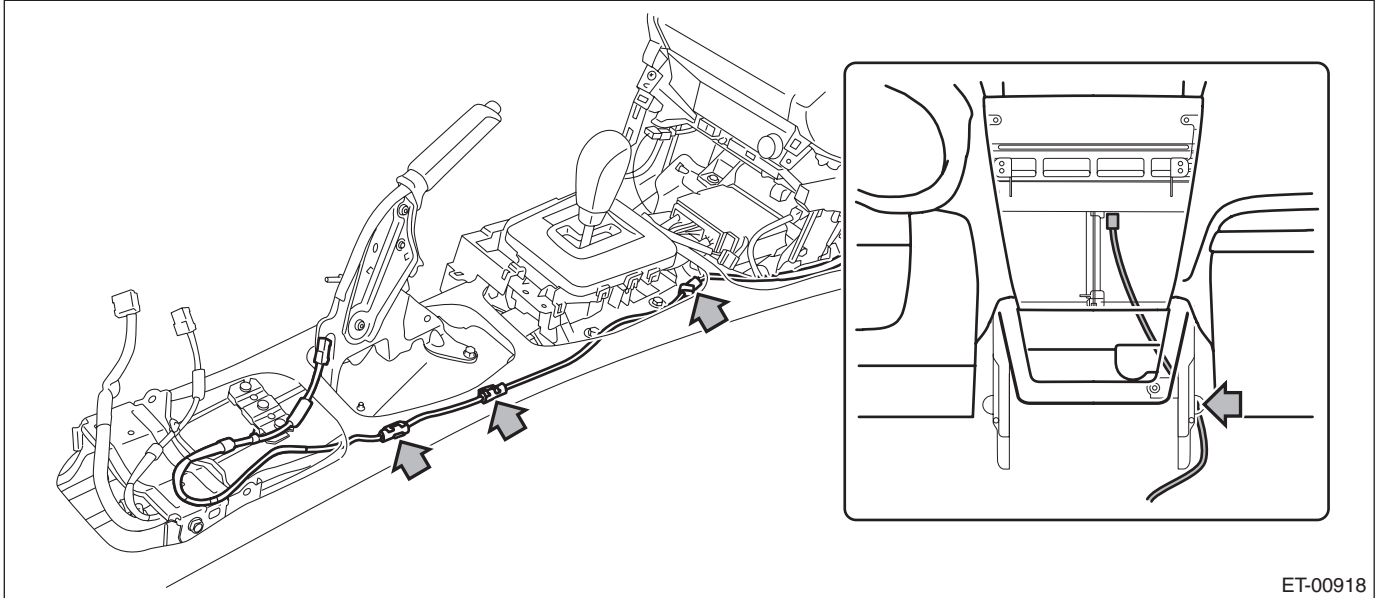

## B: INSTALLATION

### 1. AUX UNIT

- 1) Install the unit - AUX terminal.
- 2) Install the console box assembly.
- 3) Connect the battery ground terminal. <Ref. to NT-5, BATTERY, NOTE, Note.>

NOTE:

For models other than STI model, connect the ground terminal to battery sensor.

### 2. AUX FEEDER CORD

**CAUTION:**

**After installing the panel center assembly, check that the air vent grille of the panel center assembly is inserted correctly into the air vent duct.**

- 1) Install the cord assembly - AUX feeder.
- 2) Install the audio assembly or navigation assembly.
- 3) Install the panel center assembly.
- 4) Install the console box.
- 5) Connect the battery ground terminal. <Ref. to NT-5, BATTERY, NOTE, Note.>

NOTE:

For models other than STI model, connect the ground terminal to battery sensor.

# AUX Input Terminal

ENTERTAINMENT

---

# COMMUNICATION SYSTEM

*COM*

---

	Page
1. General Description .....	2
2. Relay and Fuse .....	3
3. Horn System .....	4
4. Horn .....	5
5. Horn Switch .....	10

